



About **Grootfontein Village**

Grootfontein Village is a shopping centre situated in the greater region of Sasolburg a large industrial city within the Metsimaholo Local Municipality.

With over 6,600m² of retail space Grootfontein Village is anchored by Checkers and other leading retail industry stores.

The centre is located within a close proximity to the DP DE Villiers Stadium, primary, secondary schools and colleges including Flavius Mareka TVET College, Professional Graduate College, The Hero's Security Training Colleges, Kahobotjha- Sakubusha Secondary School, Afrikaanse Hoërskool Sasolburg, Sasolburg High School, Noorde Primere Skool and Technical Secondary School Sasolburg.

With other service centres such as Fezi Ngubentombi Provincial Hospital, Sasol Eco Industrial Park and AECL mining within close proximity.



Fact Sheet



Current GLA: 6 600m²

Number of tenants:

19 stores

Anchors: Checkers

Trading hours:

Mon - Thu: 9am - 6pm

Fri: 9am - 7pm

Sat: 9am - 5pm

Sun & Public Holidays:

9am - 5pm

Managed by:

Broll

Demographics:

51% Male & 49% Female

64% Afrikaans Speaking

Age Group: 35 - 49 years

Working age: 57%

Primary catchment area:

LSM level 7, with an average

monthly household income

of between R15,550 -

R19,075*

Unique Features:

- Open Air retail environment
- Secure parking
- Greenery and unique landscaping



*www.sparkmedia.co.za/wp-content/uploads/2019/07/Roots-2019_Sasolburg-Vaal.pdf



Macro **Locality**

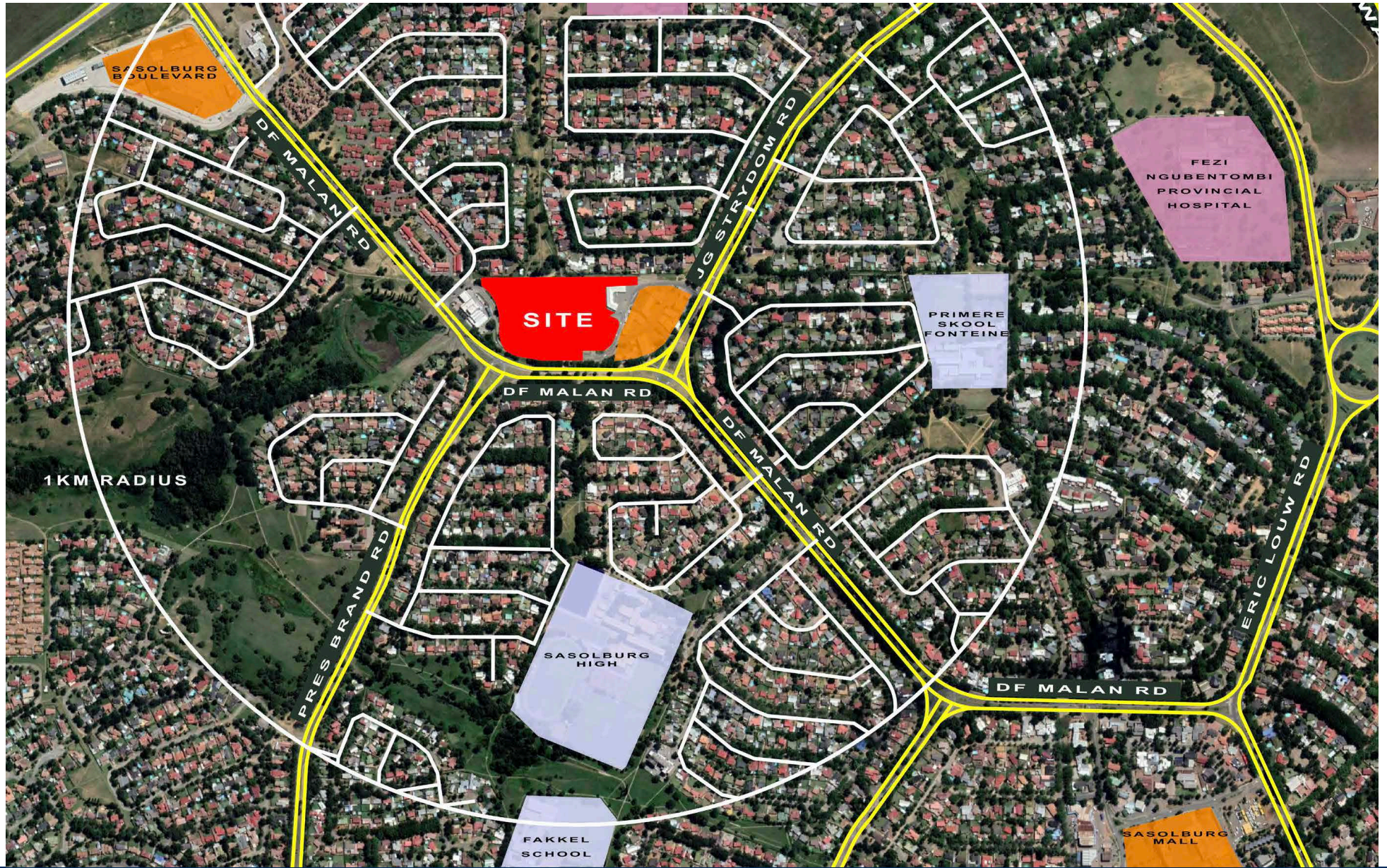

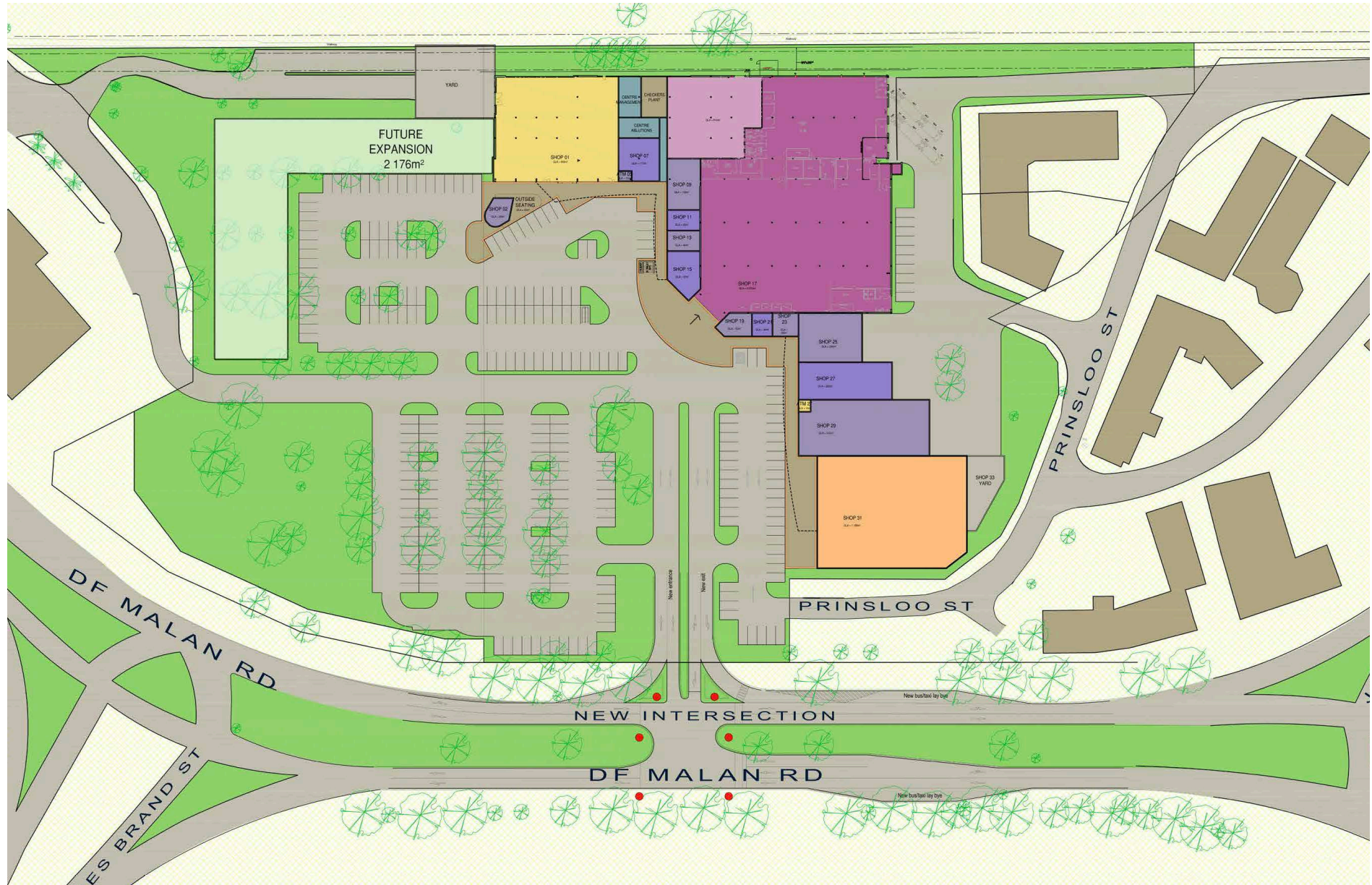

Leasing Plan





Grootfontein
GROOTFONTEIN
Village





JOHANNESBURG

Tel: +27 10 020 1810

Fax: +27 10 020 1811

Email: info@retailafrica.co.za

Web: www.retailafrica.co.za

1 Melrose Square, Amdec House,
Office 303, Melrose Arch, 2076,

P O Box 877, Melrose Arch, 2076

